

LAPAR

LPA13/14 Series

Three-way Ball Valve

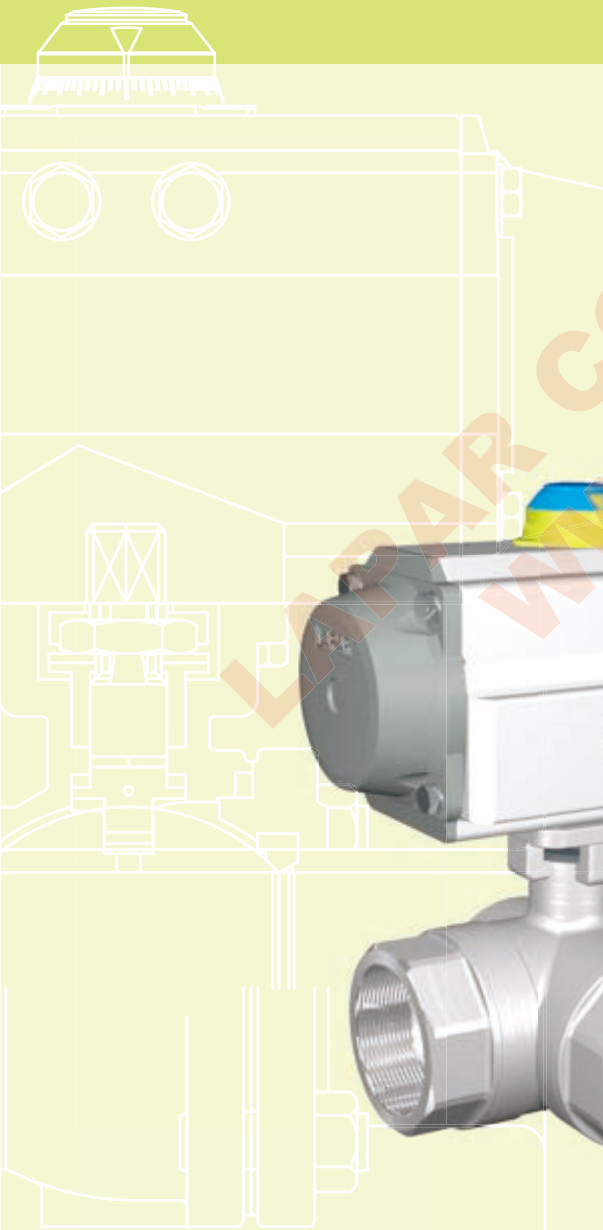

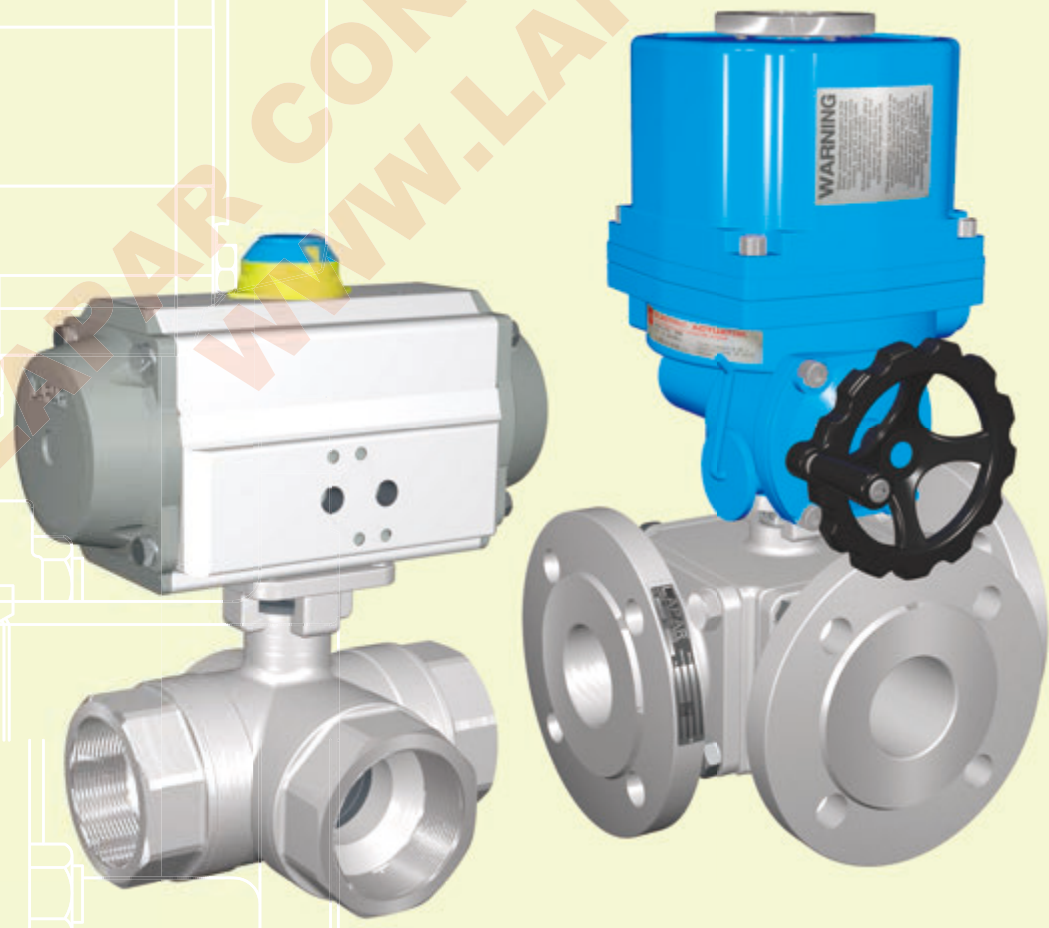
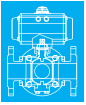

LPA13/14-

3-Way Ball Valve Product Description

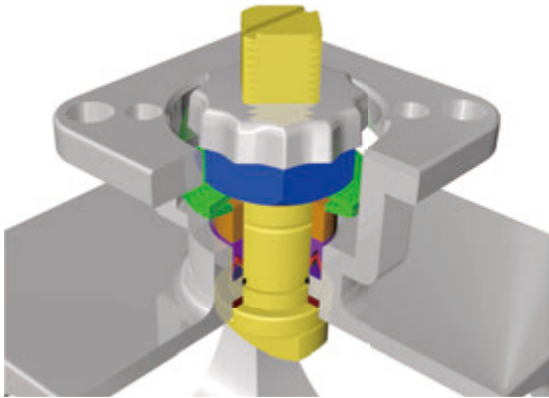

- Built-in ISO 5211 direct mounting pad for easy automation
- Anti-static devices for ball-stem-body
- Blow-out proof stem
- Double wing shrapnel design can guarantee that there is always the prestressing force compression packing
- TA-LUFT design approved

Flow Diagram

Three-way L

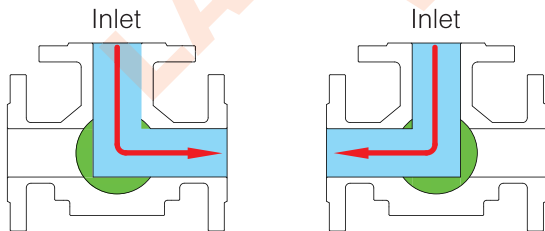

Three-way T

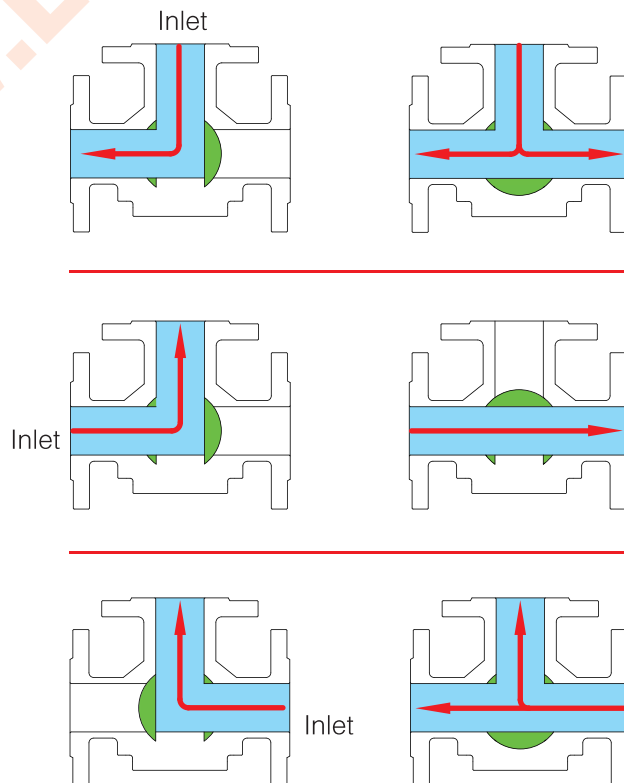

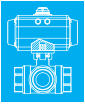

LPA14- Thread 3-way Ball Valve



Code	Actuator	Action	Air Fail Position	Control	Structure	Body	Sealing	Ball	Connection DN	PN
LPA14-	<ul style="list-style-type: none"> 1 Pneumatic 2 Pneumatic & Handwheel 3 Electric DC24V 4 Electric AC220V 5 Electric AC380V 7 Handle 8 Turbine 0 Others 	<ul style="list-style-type: none"> D Double-acting S Single-acting 0 Others 	<ul style="list-style-type: none"> 1 Normally Open 2 Normally Close 3 Flexible 4 Held 0 Others 	<ul style="list-style-type: none"> A On-off B Control C Intelligent 0 Others 	<ul style="list-style-type: none"> 8 Three-way 9 Three-way 0 Others 	<ul style="list-style-type: none"> A 316L B 316 C 304 I 304L D WCB 0 Others 	<ul style="list-style-type: none"> P PTFE Q TFM1600 T EK 0 Others 	<ul style="list-style-type: none"> A 316L B 316 C 304 I 304L 0 Others 	<ul style="list-style-type: none"> 3 Thread 	<ul style="list-style-type: none"> 0

Design Feature

- Lost-wax precision casting
- Built-in ISO 5211 direct mounting pad for easy automation
- Anti-static devices for ball-stem-body
- Blow-out proof stem
- TA-LUFT design approved
- A variety of thread standards approved

Parameter

- DN: 8~50mm
- PN: 1.6~6.3Mpa
- Design: ASME B16.34, API 608
- Pipe Thread: ASME B1.20.1, BS21, DIN 2999/259, ISO 7/1, ISO 228/1, JIS B 0203
- Inspection & Testing: API 598, EN 12266
- Applicable Temperature:
 - ▲ PTFE, TFM1600: -29°C ~ 178°C
 - ▲ EK: -29°C ~ 250°C

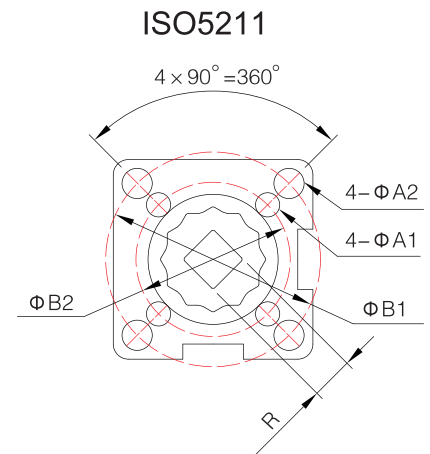
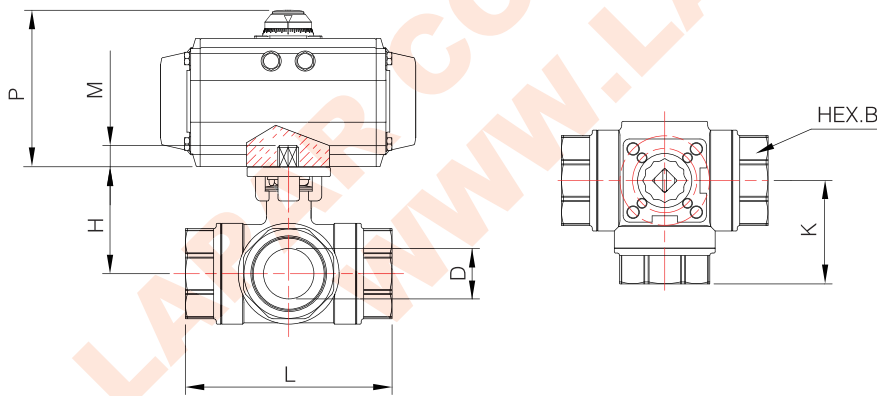

* P: Please refer to the actuator configuration table

Unit:mm

SIZE	L	D	K	H	R	HEX.B	M	A1	A2	B1	B2	ISO5211	LT-DA	LT-SR	LU	LH	
DN8	1/4"	79	11	39.5	42	9	27	9	6	6	42	36	F03-F04	LT 50	LT 50	LU 50	LH 006
DN10	3/8"	79	11	39.5	42	9	27	9	6	6	42	36	F03-F04	LT 50	LT 50	LU 50	LH 006
DN15	1/2"	79	11	39.5	42	9	27	9	6	6	42	36	F03-F04	LT 50	LT 50	LU 50	LH 006
DN20	3/4"	88	15	44	49	9	34	9	6	6	50	36	F03-F05	LT 50	LT 63	LU 50	LH 006
DN25	1"	108	20	54	59.5	11	41	11	7	6	50	42	F04-F05	LT 50	LT 75	LU 50	LH 006
DN32	1-1/4"	124	25	62	63	11	50	11	7	6	70	42	F04-F07	LT 63	LT 75	LU 50	LH 006
DN40	1-1/2"	135	32	67.5	73.5	14	56	14	9	7	70	50	F05-F07	LT 63	LT 88	LU 160	LH 006
DN50	2"	164	40	82	82.8	14	70	14	9	7	70	50	F05-F07	LT 75	LT 100	LU 160	LH 008